

IIB Bank



Architects: Michael Collins Associates
Main Contractor: M&P Construction
Architects: Michael Collins
M&E Consultants: McCarrick Woods
Mechanical Contractor: Glow Heating Ltd
Electrical Contractor: CJ Ryder Lawlor



IIB Bank PLC is one of the leading non-retail banks in Ireland with its HQ in Dublin and offices in Cork, Galway and Belfast. It provides a wide range of banking services including corporate and business banking, private banking and treasury.

IIB's headquarters is located in the busy Dublin 2 area. The building's unique design incorporates the reconstructed Archer's Garage and is linked to a modern 5 storey office building by a dramatic 3 story atrium.

Allied Workspace was awarded the full fit out of the new Headquarters. The package included suspended ceilings, stud partitions (up to 4200mm high), frameless glazed partitions, joinery (over 200 doors), timber panelling, structural glazing with associated steelwork and manifestation. The manifestation included directional and advertising signage.

ALLIED'S PACKAGE ALSO INCLUDED STRUCTURAL GLAZING. A NUMBER OF STRUCTURAL GLASS WALL FEATURES WERE INCLUDED IN THE GROUND FLOOR ATRIUM WHERE THE GLAZING WAS CLAMPED TO STRUCTURAL STEELWORK.



The suspended ceiling works at the fit out stage included removing approximately one third of the standard ceilings and replacing them with new Gypsum Line 6 board, taped and jointed. In addition, the ceilings to the Boardroom, Client Dining and circulation areas were replaced with timber paneling. A number of timber dropped ceilings with smoked glass bulkheads were installed to the Penthouse and Ground floors.

All 5 floors were fitted out with single glazed Polar partitions. Where increased sound proofing was required (meeting rooms, boardroom and Director's offices) double glazed Polar was used. All glazing was 'frameless' which along with recessed tracks give the illusion of floating glass.

The joinery package included over 200 single and double doors, along with all ironmongery. This joinery package included timber paneling to Boardroom, Client Dining, Director's Offices and Ground Floor Public and Meeting Room areas. Other special requirements were to house PA speakers and flat screen TV's in the timber.

Allied Workspace designed and manufactured structural steelwork, bolted to the concrete slab, to support the 2500mm high glazed fronts to the meeting rooms on the ground floor, where the floor to ceiling height was 3600mm. Above the glazed screens are smoked glass bulkheads built off the structural steelwork ■



DOUBLE GLAZED POLAR DOORFRAME

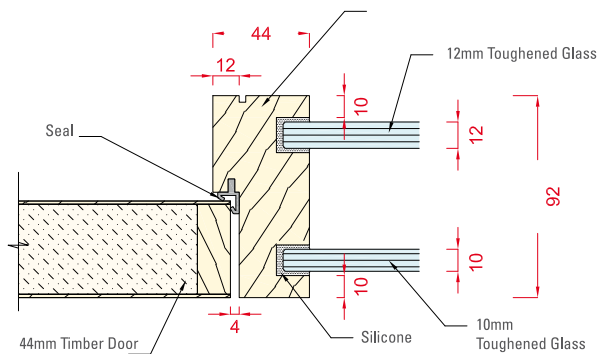

STRUCTURAL GLASS SCREEN

